

PHILIPS



Nissa Ultra Efficient
9290046317



User manual
Benutzerhandbuch
Notice d'emploi
Manual de usuario
Manual do usuário
Manuale d'uso
Gebruiksaanwijzing

Incl.

A

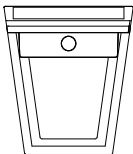

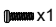
 x2  x1

 x2

B



Excl.

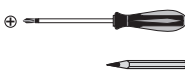
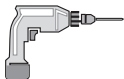

B



IP44

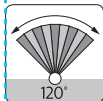
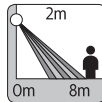
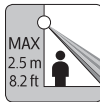

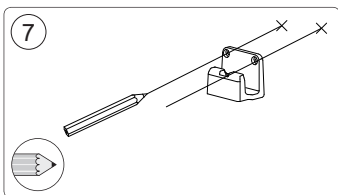
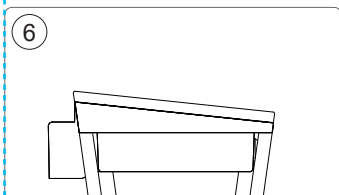
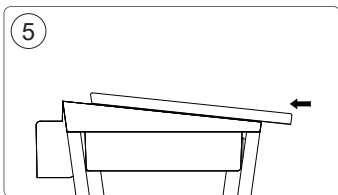
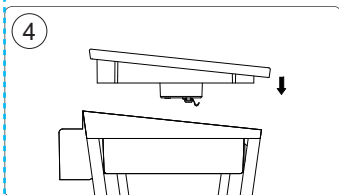
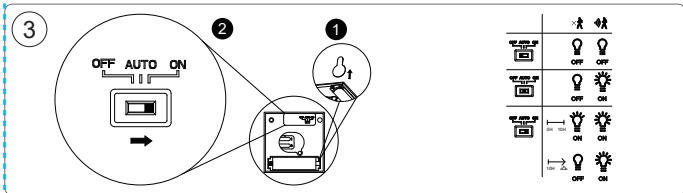
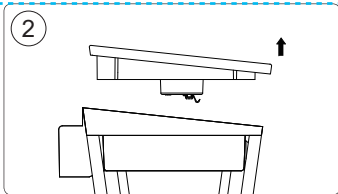
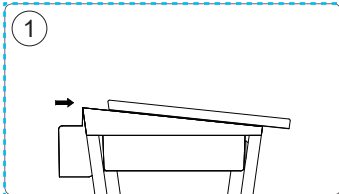

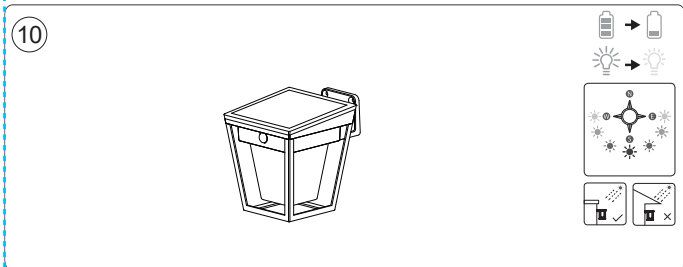
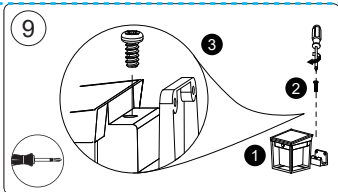
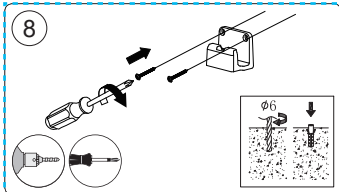

Replace Battery

1

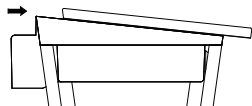

2

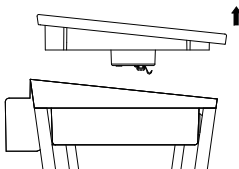

3

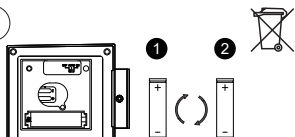

18650/3.6-3.7V Li-ion/MIN2600mAh

4

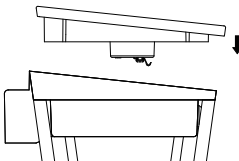

5

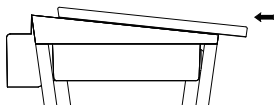

6

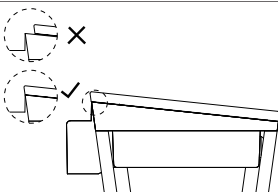



Signify Commercial UK Limited
Unit 3, Guildford Business Park, Guildford,
Surrey, GU2 8XG, UK

Signify
I.B.R.S. / C.C.R.I. Numéro 10461
5600 VB Eindhoven,
the Netherlands
☎ 00800-74454775

3241 662 11351

Philips and the Philips Shield Emblem
are registered trademarks of Koninklijke
Philips N.V. and are used under license

© 2024 Signify Holding

The Signify logo consists of a stylized lowercase "s" inside a circle, followed by the word "signify" in a lowercase, sans-serif font.

www.philips.com/lighting